

NIWIGE IVYEREKEYE:

# UKUNTU IMPWEMU NYERANDA IDUFASHA GUKORERA YEHOVA

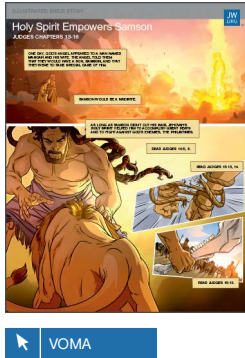

1 Soma ABACAMANZA 13-16

2 Soma ibiri kuri *bande dessinée* yigana inkuru yo muri Bibiliya

## Impwemu nyeranda yarahaye inguvu Samusoni

3 Kora utu dukorwa

## IMYAKA 3-6

### KORA

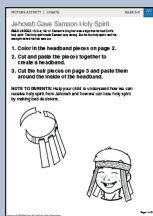

### YEHOVA YARAHAYE SAMUSONI IMPWEMU NYERANDA

INTUMBERO: Gufasha abana bawe kumenya ingene impwemu nyeranda idufasha



## IMYAKA 6-8

### KINA

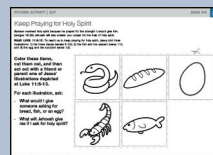

### NUGUME USABA IMPWEMU NYERANDA

INTUMBERO: Kwigisha abana bawe gusaba impwemu nyeranda y'Imana



## IMYAKA 8-12

### KAMERE NZIZA

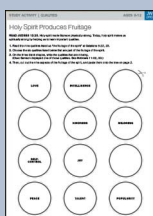

### IMPWEMU NYERANDA IRAMA ICAMWA

INTUMBERO: Gufasha abana bawe gutsimbataza icamwa c'impwemu nyeranda y'Imana



## ABARENZA 12

### URURIRIMBO N'UMWIMENYEREZO



- Soma kandi uzirikane amajambo y'ururirimbo “Imana iraduha impwemu nyeranda” mu gitabu *Turirim bire Yehova tunezerewe*
- Kora agakorwa kavuga ngo “Bibiliya ni igitabu kiva ku Mana (Igice ca 1)” kugira umenye ingene Imana yahumekeye abanditse Bibiliya



INTUMBERO: Kumenya ingene impwemu nyeranda ikora

